

TECHNICAL DATA SHEET PHOENIX PF160 FOOD



AISI 316 ELECTRO-POLISHED

TECHNICAL DATA PF160 FOOD

- FLUID CONNECTIONS :** TRI-CLAMP 1"1/2
- AIR CONNNECTION :** 1/2" BSP
- MAX FLOW RATE :** 170 lt/min
- MAX AIR PRESSURE:** 8 bar
- MAX DELIVERY HEAD:** 80 m
- MAX SUCTION LIFT DRY:** 6 m
- MAX SUCTION LIFT WET:** 9,8 m
- MAX SOLID PASSING:** 7,5 mm
- NOISE LEVEL:** 75 dB
- DISPLACEMENT FOR CYCLE:** 330 cc
- MAX VISCOSITY :** 35.000 cps
- ATEX zona 1 :** EX II 2/2 GD c IIB T135°C
- ATEX zona 2 :** EX II 3/3 GD c IIB T135°C

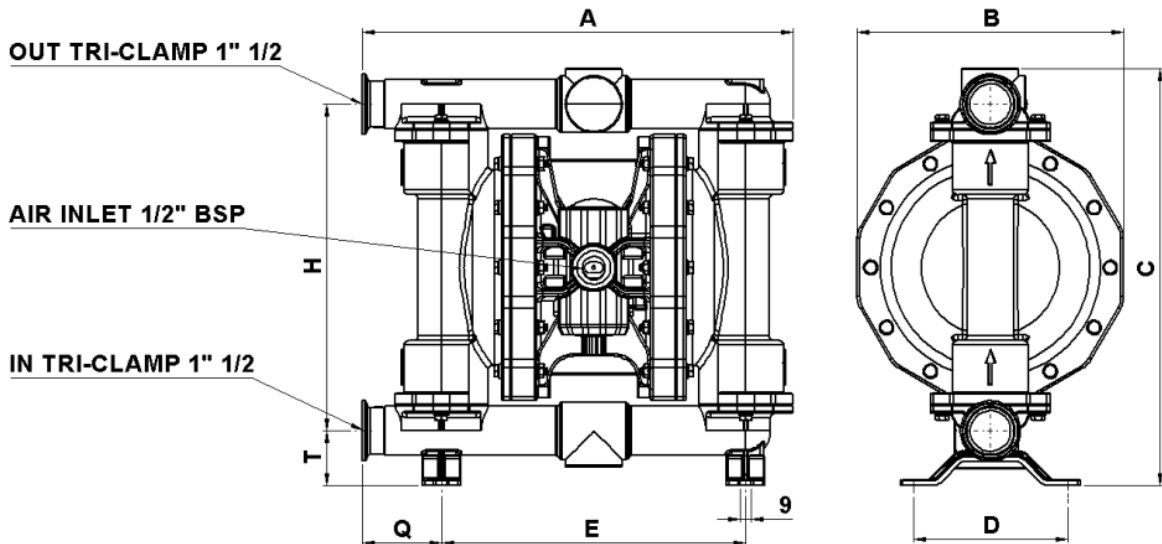
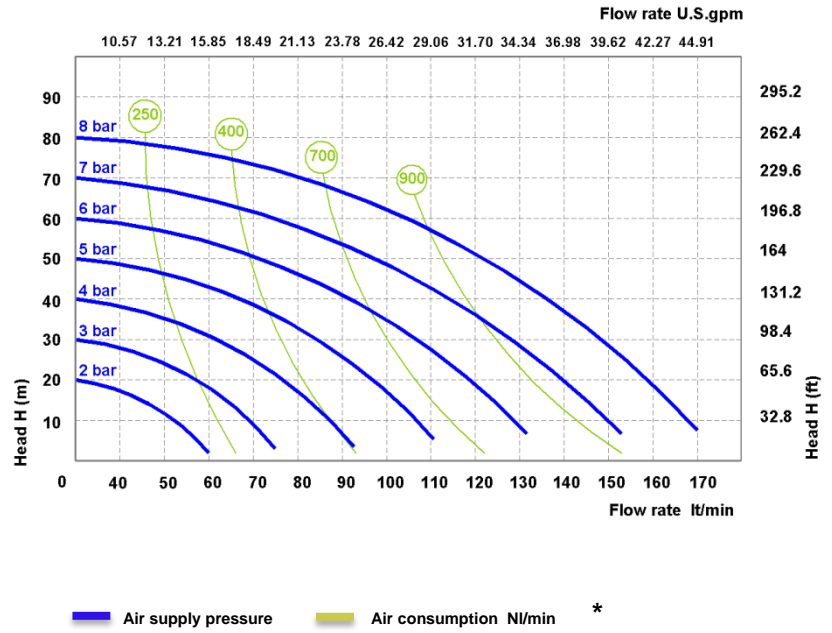

PHOENIX PF160	A	B	C	D	E	H	Q	S	T	Weight Kg	Max Temperature
AISI 316	360	222	349	129	254	273	66	9	46	20	95°C

* The curves and performance values refer to pumps with submerged suction and a free delivery outlet with water at 20°C, and vary according to the construction material. Technical data are approximate and not binding for the manufacturer who reserves the right to change them without notice at any time.

COMPOSITION

MODEL	CASING	DIAPHRAGM	BALL	SEATS	GASKET	CONNECTIONS	ATEX	PORTS IN/OUT
PF0160	S=SS POLISHED	HT=HYTREL+PTFE	T= PTFE S= SS	S=SS	T=PTFE	1=BSP 3=TRI-CLAMP	X = zone 1 - = zone 2	AB=Standard

AVAILABLE CONNECTIONS

Standard = A B
 IN = A-C
 OUT =B-D

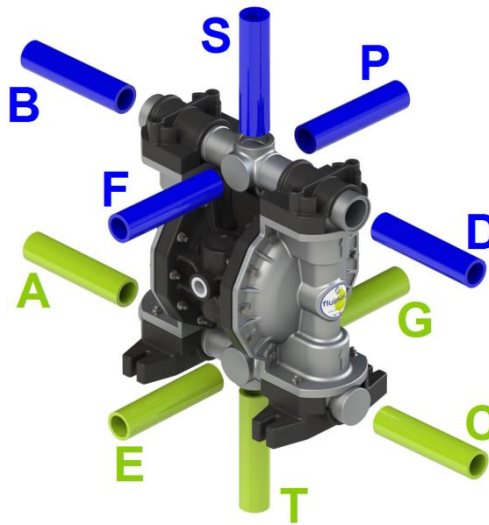

HOW TO READ THE CODE

